



LA

LEVER ACTION INSTRUCTION MANUAL

**Read the instructions and warnings in this
manual carefully before using these firearms**

GUN SAFETY RULES

Observe these rules of safe gun handling.

1. Always keep the muzzle pointed in a safe direction. Watch the muzzle at all time, never point a gun. accidentally or intentionally, at any person or anything you do not intend to shoot. Identify the target before shooting; do not shoot at sounds.
2. Always treat a gun as if it is loaded - it may be!
3. Keep your finger off the trigger while operating the action and at all other times until you are ready to shoot.
4. Keep the safety "on" or in the "safe" position at all times until you are ready to fire. Do not rely on your gun's safety, the safety on any gun is a mechanical device and is not intended as a substitute for common sense or safe gun handling.
5. Learn how your gun functions and handles. If you do not thoroughly understand the proper use and care of your gun, seek the advice of someone who is knowledgeable
6. Do not alter or modify any part of the firearm.
7. Store guns unloaded, separate from any ammunition, and out of the reach of children.
8. Be sure the barrel is clear of any obstructions before loading. Make it a habit to check the barrel every time before loading.
9. Be sure you have and use the proper ammunition. A 20 gauge shell will enter a 12 gauge chamber far enough so that a 12 gauge shell can be loaded behind it. Also, a 3 inch shell may fit into a 2 3in4ch chamber, but the crimp at the mouth of the shell will unfold into the forcing cone. If either of these things occur and you fire the gun, the gun will explode, damaging the gun and possibly causing serious injury or death to you and those around you.
10. Wear protective shooting glasses and adequate ear protection when shooting.
11. Never climb or jump over anything, such as a tree, fence, or ditch, with a loaded gun. Open the barrel, remove the shells and hand the gun to someone else or place it on the ground on the other side of the obstacle before crossing it yourself. Do not lean a gun against a tree or other object; it could fall and possibly discharge.
12. Do not shoot at a hard surface or at water. Bullet and shot can ricochet or bounce off and travel in unpredictable directions with great velocity.
13. Never transport a loaded gun. DO not place a loaded gun into a vehicle. The gun should be unloaded and placed into a case when not in use.
14. Never drink alcoholic beverages before or during shooting.

INTRODUCTION TO ETERNAL SPORTING ARMS

For many years, ETERNAL has been importing quality shotguns. Combine the old world quality with modern technology, and you have ETERNAL Shotguns. We at ETERNAL thank you for the privilege of delivering a product to you that will provide you with years of pleasurable use. Happy shot gunning.

ABOUT YOUR LEVER ACTION SHOTGUN

Your ETERNAL is manually operated. Once a shell has been fired, the locking lug in the bolt moves down, unlocking the gun. The lever can then be moved to the down and up again, ejecting and loading a new shell. To open the bolt without firing the gun, drive the lever. This allows for opening the action without dry firing.

SAFETY SWITCH OR BUTTON

The safety is designed to stop the trigger mechanism.

DON'T RELY ON YOUR GUN'S SAFETY, TREAT EVERY GUN AS IF IT WERE LOADED AND READY TO FIRE.

The safety on any gun is a mechanical device, and it is not intended as a substitute for common sense or safe gun handling. Always keep the muzzle pointed in a safe direction.

A-The safety is located behind the trigger, and provides protection against accidental or unintentional discharge under normal usage when properly used.

B-To engage the safety, push the button so that it protrudes from the right side of the gun and the

RED BAND MARKING CAN NOT BE SEEN. The safety should always be in the "on" or "safe" position until you intend to fire the gun.

C-When you are ready to fire the gun, press the safety button to the "off" position so that the safety protrudes from the left side of the gun and the **RED BAND MARKING IS SHOWING.**

DANGER: The gun will fire when the trigger is pulled intentionally or accidentally when the **RED BAND MARKING IS SHOWING**

ASSEMBLY

- 1.Remove the magazine cap.
- 2.Press upward on the action bar lock. Pull the forearm approximately halfway rearward.
- 3.Hold the barrel ahead of the barrel guide ring
- 4.Slide the barrel guide ring over the magazine tube. Clean the barrel following the instructions.
- 5.Press upward on the action bar lock.
- 6.Align the ejector on the inside of the barrel with the slot in the bolt.
- 7.Carefully set the barrel into the receiver. DO NOT FORCE IT!
- 8.Replace the magazine cap. Tighten.

DISASSEMBLY

- 1.Make sure the gun is unloaded!
- 2.Point firearm in a safe direction
- 3.Point firearm in a safe position.
- 4.Push up on the action bar lock.
- 5.Slide forearm forward halfway.
- 6.Unscrew and remove the magazine cap.
- 7.Pull the barrel carefully out of the receiver.
- 8.Push the carrier forward.
- 9.Depress and hold the action bar lock.
- 10.Slide the forearm forward and off the magazine tube.

LOADING YOUR SHOTGUN ONE SHELL ONLY

- 1.Put safety in the "on" position.
- 2.Point the gun in a safe direction.
- 3.Put your hands into lever hand guard.
- 4.Pull the lever completely to the down.
- 5.Put one shell through the ejection port, making sure it is the correct gauge and length.
- 6.Push the lever up and close the action.

FULLY LOADING YOUR SHOTGUN

- 1.Put safety in the "on" position.
- 2.Point the gun in a safe direction.
- 3.Push up on the action bar lock.
- 4.Pull the lever completely to the down.
- 5.Put one shell through the ejection port, making sure it is the correct gauge and length.
- 6.Push the lever up and close the action.
- 7.Push a shell upward against the bottom of the carrier.

THANK YOU

Thank you for purchasing a ETERNAL Shotgun. We are sure this gun will bring you years of hunting and/or shooting pleasure. Your satisfaction is the key to our success. Please let us know if we can be of service and relay any observations about your guns performance or appearance.

Model Number : _____

Purchase Date : _____

Gauge or Caliber : _____

Serial Number : _____

Purchase Price : _____



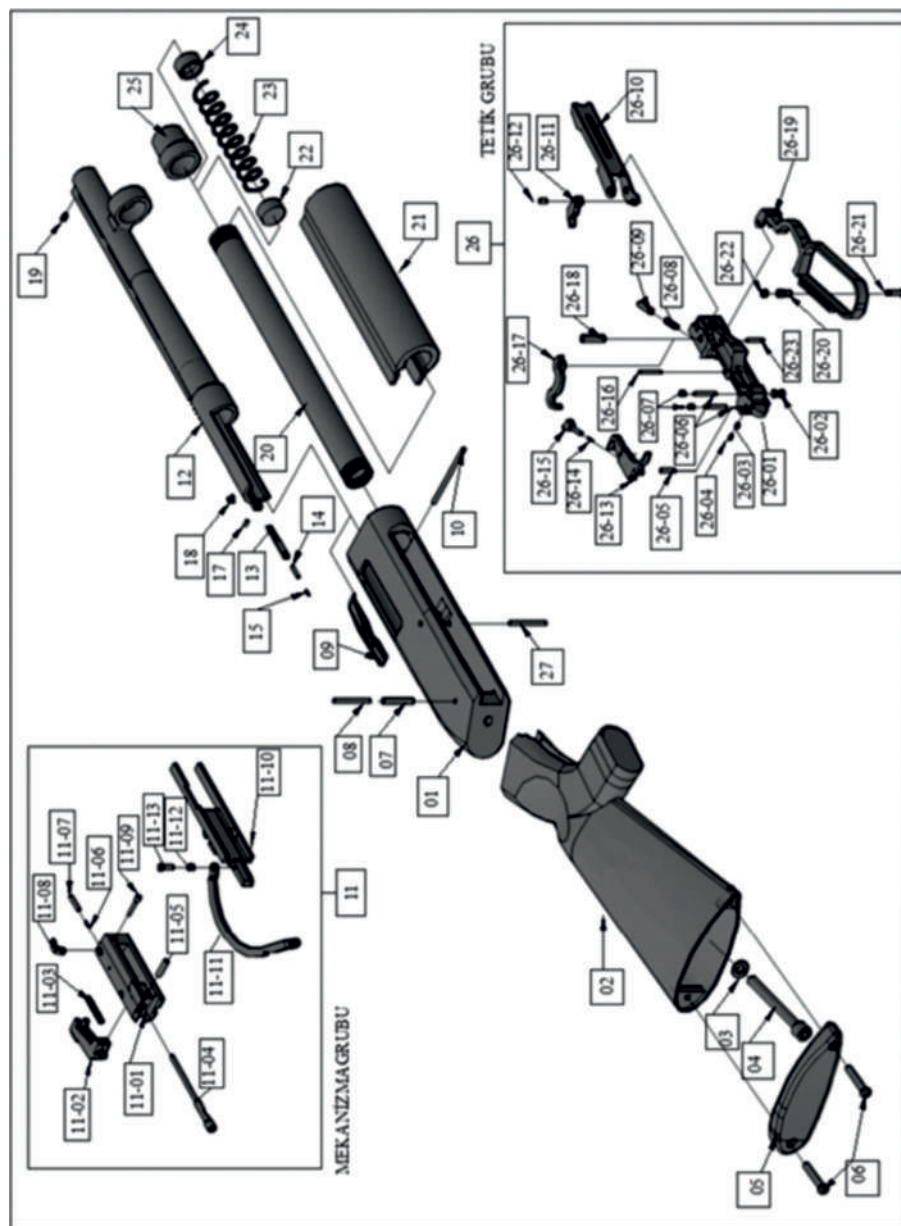



Store Name : _____



01	Receiver	19	Brass Bead
02	Stock	20	Magazine Tube
03	Stock Connection Bolt Washer	21	Forend
04	Stock Connection Bolt	22	Magazine Follower
05	Synthetic Stock Pad	23	Magazine Spring
06	Stock Pad Screws	24	Magazine End
07	Ayceki (Lever Arm) Stopper Reel	25	Barrel Connection Nut Complete
08	Ayceki (Lever Arm) Stopper Pin	26	Trigger
09	Magazine Stop Complete	26-01	Trigger Body
10	Magazine Stop Connection Pin	26-02	Safety
11	Bolt	26-03	Safety Push Reel
11-01	Bolt Body	26-04	Safety Push Spring
11-02	Locking Lug	26-05	Safety Push Connection Pin
11-03	Firing Pin Spring	26-06	Ayceki (Lever Arm) Stop Connection Pins
11-04	Firing Pin	26-07	Ayceki (Lever Arm) Stop Reels
11-05	Firing Pin Connection Pin	26-08	Operating Handle Spring
11-06	Extractor Spring	26-09	Operating Handle Reel
11-07	Extractor Pin	26-10	Carrier
11-08	Extractor	26-11	Carrier Hand
11-09	Extractor Connection Pin	26-12	Carrier Connection Pin
11-10	Bolt Carrier	26-13	Trigger
11-11	Ayceki (Lever Arm)	26-14	Hammer Sear Spring
11-12	Ayceki (Lever Arm) Connection Nut	26-15	Hammer Sear
11-13	Ayceki (Lever Arm) Connection Bolt	26-16	Hammer Sear Connection Pin
12	Barrel	26-17	Hammer
13	Ejector	26-18	Hammer Connection Reel
14	Ejector Pin	26-19	Operating Hand Lever
15	Ejector Pin Spring	26-20	Ayceki (Lever Arm) Connection Pin
17	Ejector Screw Front	26-21	Ayceki (Lever Arm) Handle Reel Screw
18	Ejector Screw Back	26-22	Ayceki (Lever Arm) Handle Reel
		26-23	Ayceki (Lever Arm) Connection Screw
		27	Trigger Guard Dissassembly Pin

USAGE OF CHOKE TUBES

The choke controls how open or tight the pattern of the shot will be. The chart below lists the chokes available (from open to tight), and the cores pending marks that indicate the specific choke.

	SKEET	IC	M	IM	F	XF
CHOKE TUBE						
BBLs	CL	****	***	**	*	XF

Never fire your gun or run cleaning tools through a barrel that uses a choke tube without having a choke installed. The threads of the choke tube and the internal threads of the barrel should be cleaned after each use and before installation of the tube. Your ETERNAL shotgun uses choke tubes.

To install a tube, insert the tube into the top of the barrel and tighten with your fingers.

Once the tube is finger tightened, tighten the rest of the way with the appropriate choke tube wrench until the tube is snug. DO NOT over tighten or forcefully tighten with the wrench.

MAINTENANCE AND CLEANING

Caution : Make sure the gun is UNLOADED.

1. Make sure the broad, polished finely fitted mating surface of the breech block and receiver is especially clean and lightly oiled with high quality gun oil. Do not use silicone or lanolin (Do not use WD-40).

2. Run an oil patch through the bore with a cleaning rod starting from the breech end. To prevent leading, use a cleaning solvent and brass brush to clean the bore periodically.

Follow this cleaning with one or two clean oil patches. Important: If your gun is equipped with choke tubes, do not use a brass brush to clean the barrels without having a choke tube installed. Barrels that utilize choke tubes must also have the choke tubes removed to clean and oil the threads inside the barrel and the choke tubes themselves. This will protect the threads and prevent dirt build up that can cause tubes to become difficult to remove.

Never fire your gun without choke tubes snugly tightened in barrels. Do not over tighten choke tubes. Wipe all exposed metal surface with an oiled cloth before storing. Do not squirt or pour oil into the inside mechanism because it may hamper proper functioning. After extended periods of heavy use, your gun should be taken to a qualified gunsmith to have the action disassembled for professional cleaning and lubrication.

3. Care for your wood stock and forearm the same way you would a piece of furniture with the same finish.

USAGE OF CHOKE TUBES

Caution : Make sure the gun is UNLOADED.

1. Make sure the broad, polished finely fitted mating surface of the breech block and receiver is especially clean and lightly oiled with high quality gun oil. Do not use silicone or lanolin (Do not use WD-40).

2. Run an oil patch through the bore with a cleaning rod starting from the breech end. To prevent leading, use a cleaning solvent and brass brush to clean the bore periodically. Follow this cleaning with one or two clean oil patches. Important: If your gun is equipped with choke tubes, do not use a brass brush to clean the barrels without having a choke tube installed. Barrels that utilize choke tubes must also have the choke tubes removed to clean and oil the threads inside the barrel and the choke tubes themselves. This will protect the threads and prevent dirt build up that can cause tubes to become difficult to remove.

Never fire your gun without choke tubes snugly tightened in barrels. Do not over tighten choke tubes. Wipe all exposed metal surface with an oiled cloth before storing. Do not squirt or pour oil into the inside mechanism because it may hamper proper functioning. After extended periods of heavy use, your gun should be taken to a qualified gunsmith to have the action disassembled for professional cleaning and lubrication.

3. Care for your wood stock and forearm the same way you would a piece of furniture with the same finish.



Eternal Arms İnşaat Silah San. İç ve Dış Tic. Ltd. Şti.

☎ +90 542 530 53 01

📍 Hacıakif Mahallesi Özdilek Caddesi No.86/B Beyşehir - Konya / TURKEY

🌐 www.eternalarms.com.tr ✉ export@eternalarms.com.tr

📘 Eternal Arms @ eternal_arms