



OVER AND UNDER SHOTGUN OWNER'S MANUAL



FOR MODEL POSEIDON



READ AND UNDERSTAND ALL OF THE CAUTIONS AND
PROPER HANDLING PROCEDURES AND INSTRUCTIONS
OUTLINED IN THIS BOOKLET BEFORE USING YOUR
NEW FIREARM.

Thank you for buying an Eternal over and under shotgun, and welcome to the family.

We believe that safe firearms handling is the most important consideration of anyone who uses firearms and ammunition. Please take a few minutes to thoroughly read and understand this instruction manual included with this shotgun.

You should completely understand this manual before you practice loading, unloading and firing with live ammunition.



REMEMBER, FIREARMS SAFETY DOES DEPEND ON YOU!

Always keep this manual with your firearm. Make sure you understand all the warnings, operation instructions and safety procedures. When you lend, give or sell the firearm, be sure this manual goes with it.

The below Commandments of Firearm Safety should be etched in your memory forever. Let them govern your action wherever and whenever you're involved with firearms in the field, on the range, or in your home. Please take the time to review and understand these rules.

1. Always keep the muzzle pointed in a safe direction. Watch the muzzle at all time, never point a gun, accidentally or intentionally, at any person or anything you do not intend to shoot. Identify the target before shooting.
2. Always treat gun as if it is loaded – it may be!
3. Keep your finger off the trigger while operating the action and at all other times until you are ready to shoot.
4. Keep the safety “on” or in the “safe” position at all times until you're ready to fire. Do not rely on your gun's safety, the safety on any gun is a mechanical device and is not intended as a substitute for common sense or safe gun handling.
5. Learn how your gun functions and handles. If you do not thoroughly understand the proper use and care of your gun, seek the advice of someone who is knowledgeable
6. Do not alter or modify any part of the firearm.
7. Store guns unloaded, separate from any ammunition, and out of the reach of children
8. Be sure the barrel is clear of any obstructions before loading. Make it a habit to check the barrel every time before loading.

- 9.** Be sure you have and use the proper ammunition. A 20 gauge shell will enter a 12 gauge chamber far enough so that a 12 gauge shell can be loaded behind it. Also, a 3" shell may fit into 2 ¾ "chamber, but the crimp at the mouth of the shell will unfold into the forcing cone. If either of these things occurs and you fire the gun, the gun will explode, damaging the gun and possibly causing serious injury or death to you and those around you.
- 10.** Wear protective shooting glasses and adequate ear protection when shooting.
- 11.** Never climb or jump over anything, such as a tree, fence with a loaded gun. Open the barrel, remove the shells and hand the gun to someone else or place it on the ground on the other side of the obstacle before crossing it yourself. Do not lean a gun against a tree or other object; it could fall and possibly discharge.
- 12.** Do not shoot at a hard surface or at water. Bullet and shot can ricochet or bounce off and travel in unpredictable directions with great velocity.
- 13.** Never transport a loaded gun. DO NOT place a loaded gun into a vehicle. The gun should be unloaded and placed into a case when not in use.
- 14.** Never drink alcoholic beverages before or during shooting.



READ AND FULLFILL ALL WARNINGS

Now that you're a gun owner you have the obligation to help ensure that shooting sports are safe for everyone participants and bystanders alike. You can do that by practicing these principles of firearm safety and passing them on to others especially new shooters. Set an example for beginners. Be a guide to their safe entry into the exciting world of shooting sports. Invest your time and patience for the love of the sport and for its future. After all, it's your love of the sport that led you to buy a new Eternal shotgun.

Firearm ownership is a right and privilege. It's a privilege which carries with it a personal responsibility to use your firearm in a way which will ensure your safety and the safety of others. The preservation of this right and privilege depends on the personal commitment of you and your fellow shooters to the safe and responsible use of firearms. Let the Commandments of Firearm Safety outlined in this book guide you at all times. Teach and promote these rules whenever you can. Remember, firearm safety depends on you! That's the only way to really enjoy your new firearm and to preserve sport shooting as we know it today.

ABOUT YOUR OVER AND UNDER SHOTGUN

Poseidon is a two barreled shotgun with the barrels aligned one over the other. It has two separate barrels that allow a rapid second shot when needed. The trigger is a single selective style, and only one barrel will be fired with each pull of the trigger. After one barrel has been fired, the trigger shifts itself into position to fire the second barrel when the trigger is pulled for the second shot.

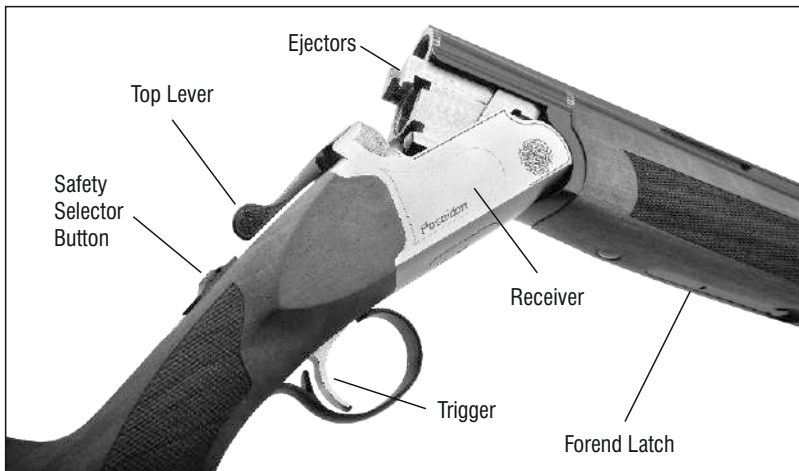
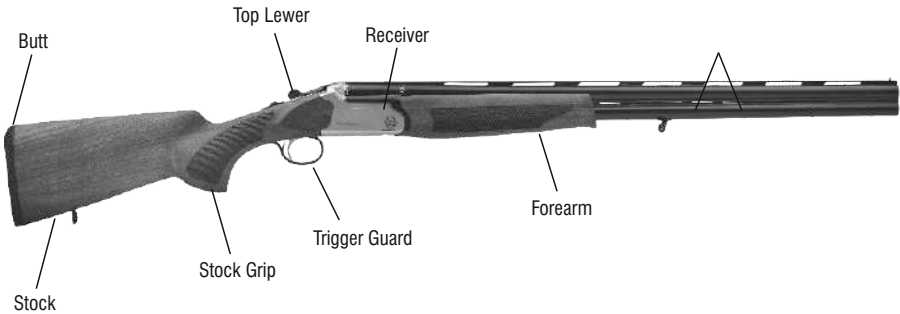

SAFETY

The safety button and barrel selector switch is located on the top rear portion of the receiver and must be manually moved to the desired position by the shooter. The safety button's position affects both barrels.

The barrel selector switch requires the user to move the safety button to the SAFE position before selecting which barrel should be fired first. To engage the safety button to the SAFE position, the safety button must be moved fully rearward. The safety button will now expose an -S- located just in front of the safety button. The -S- is a training aid used only to show the direction of the SAFE position and should not be used as an indicator that the safety is -on- -or- -off.-

Moving the safety button forward toward the muzzle of the shotgun will place the safety button in the FIRE position.



“SAFE” Position



“FIRE” Position

SELECTOR FUNCTION

To select the upper barrel, push the selector button to the left until the selector button aligns with letter U . In this position you can fire the upper barrel. To select the lower barrel, push the selector button to the right until the selector button aligns with letter O . In this Position you can fire the lower barrel.

TOP LEVER

The top lever operates the locking bolt, which is hand fitted to the barrel lugs. Moving the top lever to the right unlocks the action and allows the shotgun to be loaded and unloaded.

It is not necessary that the top lever return to a completely centered position, nor should it be hanging over the right side or edge of the receiver tang as you look down on it. Upon closing your gun, let the top lever snap into position to allow the top lever spring to return the top lever mechanism to the locked position. Do not retard its action with your thumb. Many shooters lightly push the top lever to the left after the closing the breech. This operation is a quick method of assuring yourself that foreign matter has not interfered with the complete closure of the breech.



ASSEMBLY

Before you begin to assemble the shotgun, you **MUST** look down the barrels from the breech end toward the muzzle end to make sure there is no ammunition in the chambers or obstructions in the barrels, and make sure the safety is in the "safe" position. Your shotgun was shipped with the barrel assembly (barrels and forend) detached from the receiver assembly.

1. Pull the latch on the forearm that is mounted on the barrel.
2. Detach the forearm from the barrel
3. Push the top lever fully to the right.
4. While keeping the top lever pushed to the right install the barrel to the receiver with an approximately 40 degree angle. Be sure the barrel is completely installed to the receiver otherwise shotgun will not close.
5. Be sure that ejectors are properly installed in the receiver.
6. By forcing the barrel upwards close the shotgun, be sure the barrel and receiver are properly aligned and top lever returns to slightly to the right center. It is normal that the top lever does not return exactly to the center, this allows for wear.
7. Mount the forearm to the barrel . Be sure the opening latch of forearm is completely closed.
8. Put the safety **SAFE** position by moving the safety button to rear position.

WARNING:

When assembling your shotgun, do not use undue force when closing the action. If the top lever is not to the right or the action and barrels are not properly aligned undue force will only cause them to grind together and score or mar the finely fitted surfaces.

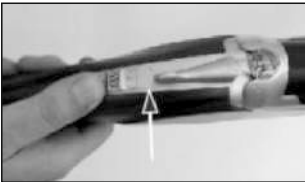

LOADING and FIRING

WARNINGS:

- * Always keep your fingers away from the trigger if you do not intend to fire.
- * Always check barrels to see that the firearm is not already loaded.
- * While you load the firearm, always point the barrel in a safe direction.
- * Always use the correct ammo size, which your firearm is chambered.
- * Always keep the safety -ON- while loading your firearm.

Load the firearms as follows;

1. Open your shotgun by pushing the top lever to the right while pushing the barrel downward.
2. Install the suitable cartridges according to the shotgun's gauge and chamber length.
3. Close your shotgun. Your shotgun is now loaded. You should move the safety to the forward position and pull the trigger to fire.
4. With safety on, move the selector located inside the safety to the right to fire the bottom barrel first. After firing the bottom barrel will fire with another pull of trigger.
5. With safety on, move the selector located inside the safety to the right to fire the top barrel first. After firing the top barrel will fire with another pull of trigger.
6. After shooting , open the shotgun by pushing the top lever fully to the right. Fired cartridges will be lifted for easy removal or ejected if your is fitted with automatic ejectors.



AFTER SHOOTING, IMMEDIATELY PLACE THE SAFETY IN THE "SAFE" POSITION.

USAGE OF CHOKE TUBES

Shotgun choke is a constriction in the end of a shotgun barrel which focuses the shot into a tighter stream—much like a nozzle on the end of a water hose, which does exactly the same thing for exactly the same reason.

There are 5 different screw-in (inner) chokes that can be used on your firearm.

- 1) F (Full /)
- 2) IM (Improved Modified //)
- 3) M (Modified ///)
- 4) IC (Improved Cylinder ////)
- 5) CYL (Cylinder /////)

3-choke system consists of F, M, CYL chokes. 5-choke system contains all the inner chokes being F, IM, M, IC, Cyl-Skeet.

Check the number and markings on the chokes to find out the inner choke configuration of your firearm. All screw-in (inner) chokes have one, two, three, four or five notches, which indicate the type of the screw-in choke, i.e. F choke has one, IM has two, M has three, IC has four and Cyl-Skeet has five notches. Please also check the markings on chokes.

Note: M, IC and Cyl-Skeet choke tubes are good for steel shot. F choke is for lead shot only!

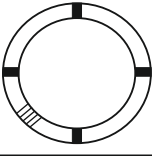
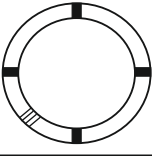
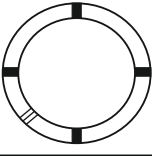
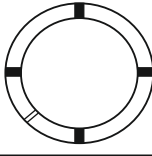
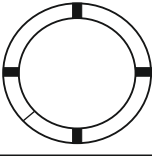
	SKEET	IC	M	IM	F
CHOKE TUBE					
BBLS	CL	HHHH	HHH	HH	H

WARNING:

- 1. Make sure the shotgun is unloaded and the safety -ON- before you assemble/disassemble the chokes.
- 2. Under safety conditions (cartridge chamber empty, receiver empty, magazine tube empty, safety engaged), check whether the choke worked loose during use. In such a case, the choke must be tightened to the end by means of the choke wrench.

CARE AND CLEANING

WARNING: Place the safety in the -safe- position and lock the bolt the rear. Be certain your shotgun's magazine, feed mechanism and chamber are unloaded. Always wear protective safety glasses during all assembly, disassembly and cleaning procedures.

Disassemble, clean and lubricate the shotgun when grease, dirt or powder fouling accumulates in the barrel and action. To avoid rust and corrosion, clean and lubricate after each use.

Materials and equipment necessary for cleaning and lubrication; Cleaning rod, Cotton bore patches, Brass bore brush, Powder solvent, Small soft brush, Good quality shotgun oil.

- After use, to remove any powder and lead residue in the bore, scrub the barrel and chamber using the bore brush with powder solvent. Then swab the bore and the chamber with shotgun oiled cotton patches to protect from rust and corrosion.
- After a high number of shots (about 500 shots), disassemble the bolt assembly and clean it with a soft brush and shotgun oil. Then dry it carefully with a soft cloth and oil the parts lightly.
- Clean the outside of the magazine tube with a shotgun oiled soft cloth and then dry it with a soft cloth and oil the parts lightly.
- Any powder on the chamber, barrel, etc. can be cleaned with a brush and powder solvent.
- All external surfaces should be wiped down with light coat of rust preventative.
- Avoid using too much solvent for bore cleaning, since prolonged contact may damage the finish of the shotgun. Make sure to wipe away all the excess solvent and lubricant.

STORAGE

Clean thoroughly and oil your gun before storage. Store the gun in a case to prevent scratches and dents. Store your shotgun in a dry place to prevent corrosion. Store the gun away from children and in a place where it cannot be obtained by those unauthorized to use it. Always store gun unloaded and separately from any ammunition.

OVER UNDER GENERAL ASSEMBLY AND PART LIST

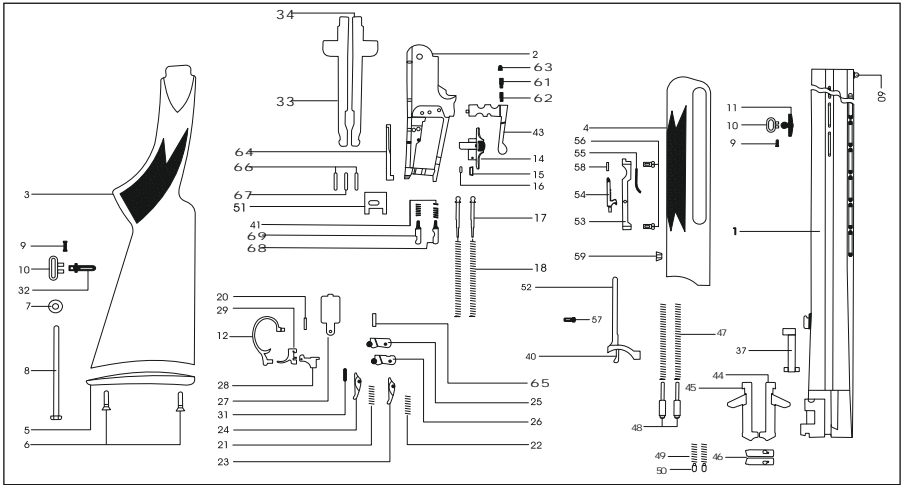

- | | |
|----------------------------|------------------------------------|
| 1- BARREL | 37- EXTRACTOR |
| 2- RECEIVER | 40- FOREARM COCKING ARM |
| 3- STOCK | 41- FIRING PIN SPRING |
| 4- FOREARM | 43- TOP LEVER |
| 5- BUTT PLATE / RECOIL PAD | 44- LEFT EJECTOR EXTRACTOR |
| 6- BUTT PLATE SCREW | 45- RIGHT EJECTOR EXTRACTOR |
| 7- STOCK BOLT WASHER | 46- LEFT AND RIGHT LEVER EXTRACTOR |
| 8- STOCK BOLT | 47- EJECTOR EXTRACTOR SPRINGS |
| 9- SWIVEL PIN | 48- EJECTOR EXTRACTOR PINS |
| 10- SWIVEL | 49- EJECTOR LEVER SPRING |
| 11- FRONT SWIVEL STUD | 50- EJECTOR EXTRACTOR LEVER PIN |
| 12- TRIGGER GUARD | 51- LOCKING BLOCK |
| 14- SAFETY SELECTOR | 52- FOREARM IRON |
| 15- SAFETY PIN | 53- TAKE DOWN LATCH BRACKET |
| 16- SAFETY SPRING PIN | 54- TAKE DOWN LATCH |
| 17- HAMMER SPRING PLUNGER | 55- TAKE DOWN LATCH SPRING |
| 18- HAMMER SPRING | 56- FOREARM SCREW |
| 20- TRIGGER PIN | 57- ESCUTCHEON SCREW |
| 21- SEAR-SAFETY SPRING | 58- TAKE DOWN LATCH PIN |
| 22- SEAR-SAFETY SPRING | 59- ESCUTCHEON MORTISE LOCH |
| 23- SEAR (RIGHT) | 60- FRONT BEAD |
| 24- SEAR (LEFT) | 61- TOP LEVER PLUNGER |
| 25- HAMMER (LEFT) | 62- TOP LEVER SPRING |
| 26- HAMMER (RIGHT) | 63- TOP LEVER PIN |
| 27- LOWER RECEIVER | 64- COCKING ARM |
| 28- SAFETY EXTRACTOR | 65- HAMMER PIN |
| 29- SINGLE TRIGGER | 66- LOWER RECEIVER PIN |
| 31- SEAR PIN | 67- FIRING PIN RETAINING PIN |
| 32- STOCK SWIVEL STUD | 68- FIRING PIN (TOP) |
| 33- LEFT EXTRACTOR | 69- FIRING PIN (BOTTOM) |
| 34- RIGHT EXTRACTOR | |

NOTES

.....

.....

.....

.....

.....

.....

.....

.....

.....

.....

.....

.....

.....

.....

.....

READ AND UNDERSTAND ALL OF THE CAUTIONS AND PROPER HANDLING PROCEDURES OUTLINED IN THIS BOOKLET BEFORE USING YOUR NEW SHOTGUN.

DO NOT, UNDER ANY CIRCUMSTANCES, ALTER THE TRIGGER, SAFETY OR OTHER PARTS OF THE FIRING MECHANISM OF THIS OR ANY OTHER SHOTGUN. FAILURE TO OBEY THIS WARNING MAY RESULT IN INJURY OR DEATH TO YOURSELF OR OTHERS.

IF YOUR SHOTGUN SHOULD REQUIRE SERVICE OR REPAIRS, PLEASE CONTACT YOUR DEALER AT FIRST. FOR OTHER TECHNICAL QUESTIONS ABOUT YOUR SHOTGUN, YOU MAY CONTACT US DIRECTLY;



Eternal Arms İnşaat Silah San. İç ve Dış Tic. Ltd. Şti.

T: +90 542 530 53 01

Hacıakif Mahallesi Özdilek Caddesi No.86/B Beyşehir - Konya / TURKEY

www.eternalarms.com.tr

export@eternalarms.com.tr